



MEDICAL PAVILION AT  
WHITE OAK

at Adventist HealthCare White Oak Medical Center  
11886 HEALING WAY  
SILVER SPRING, MARYLAND

## SMALL SUITE: FLOOR PLAN + LEGEND

Suite - 1,305 RSF

- 1** Waiting Room
- 2** Nurse Station
- 3** Exam Room
- 4** Office
- 5** Toilet
- 6** Break Area

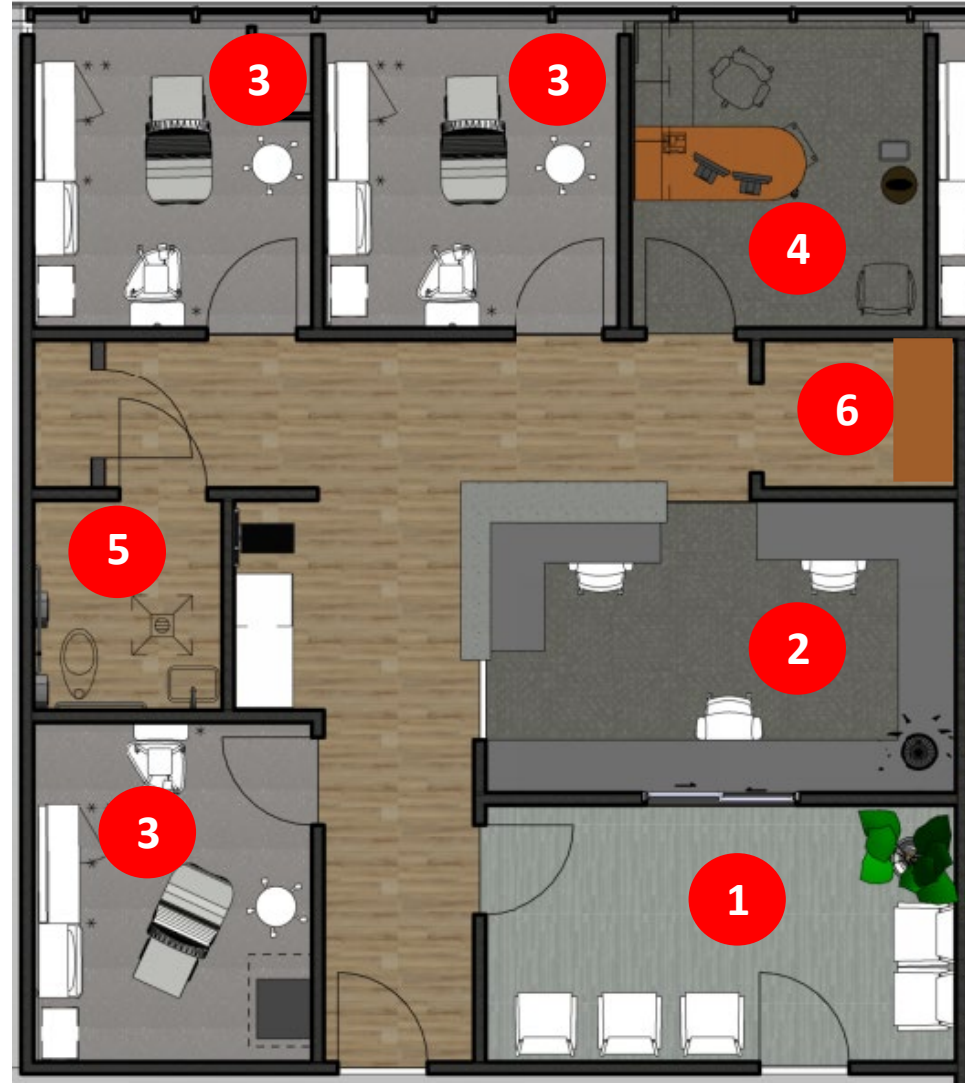

Please be advised that this rendering (this "Rendering") represents design intent and concept only, is only being used for presentation purposes, and is not intended, and should not be relied upon for architecture, construction, development, building, life safety, fire safety, or other purposes. This Rendering is not an architectural or construction drawing, it is not drawn to any scale, and is not intended to comply with any relevant building, fire, life safety, zoning, construction or other codes, ordinances, laws, rules, regulations, or with any national or local drawing standards promulgated or supported by organizations such as the American Institute of Architects. Any materials, structures, or objects depicted or reflected in the Rendering, such as carpet, paint, windows, walls, furniture, fixtures, and equipment are conceptual are not guaranteed to be provided, arranged, or installed in any manner by Cushman & Wakefield or any other entity. Cushman & Wakefield disclaims all warranties in connection with this Rendering, express or implied, including, but not limited to implied warranties of merchantability, fitness for a particular purpose, and non-infringement. Cushman & Wakefield assumes no responsibility or liability for any legal claims resulting from any use of this Rendering, by or from any party, whatsoever. Cushman & Wakefield reserves all rights not expressly reserved hereunder, including any rights and entitlement arising under intellectual property or copyright law or under contract. This Rendering does not and is not intended to confer, convey, or assign any license under any existing intellectual property or copyright law to the user.





Trammell Crow Company



MEDICAL PAVILION AT  
**WHITE OAK**

at Adventist HealthCare White Oak Medical Center  
**11886 HEALING WAY**  
**SILVER SPRING, MARYLAND**

**Matthew Sullivan**  
+1 202-266-1187  
[matt.sullivan@cushwake.com](mailto:matt.sullivan@cushwake.com)

**Lindsey Groom**  
+1 202-266-1303  
[lindsey.groom@cushwake.com](mailto:lindsey.groom@cushwake.com)

**Kirsten Ryan**  
+1 202-407-8198  
[kirsten.ryan@cushwake.com](mailto:kirsten.ryan@cushwake.com)

**Jack Seher**  
+1 202-266-1306  
[jack.seher@cushwake.com](mailto:jack.seher@cushwake.com)